

Wiley Electronics LLC Washer, Electrical Equipment Bonding (WEEB)

The WEEB is a new patent pending device for bonding PV modules to a mounting structure. The WEEB is designed to provide a reliable electrical connection with anodized aluminum pieces. In use, the WEEB is inserted between the PV module and mount at two of the four clamping points. The module and mount are then clamped together in the usual manner.

material: 304 stainless steel

UL467 listed

maximum electrical equipment ground conductor size when used with 2 WEEBs

contacting each module in an assembly: 6 AWG

outdoor rated

model number:	WEEB-CMC	for use with Conergy rails
	WEEB-DMC	for use with Direct Power and Water rails
	WEEB-PMC	for use with ProSolar rails
	WEEB-SMC	for use with Schueco rails
	WEEB-UMC	for use with UniRac rails

WEEB-CMC

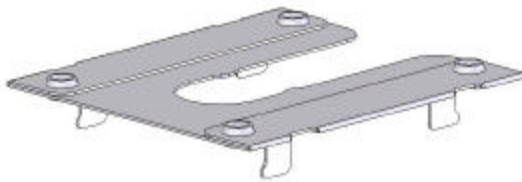

WEEB-DMC



WEEB-PMC

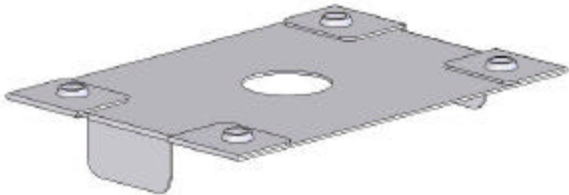

WEEB-SMC

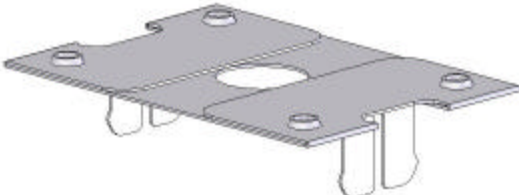

WEEB-UMC

